

ST-IA02 SIP -10.1" Indoor Monitor

Key Characteristics

Basic Function

- 10.1" capacitive touch screen
- Support custom wallpaper and screensaver
- Multi - indoor monitor in one apartment
- Voice message, blacklist, whitelist feature
- RS485 for smart home setting
- 8 defense zone alarm input
- Support call forwarding
- Easy configuration with APP by scanning QR Code
- Support real time surveillance to outdoor/villa station, IP camera



Typical Topology

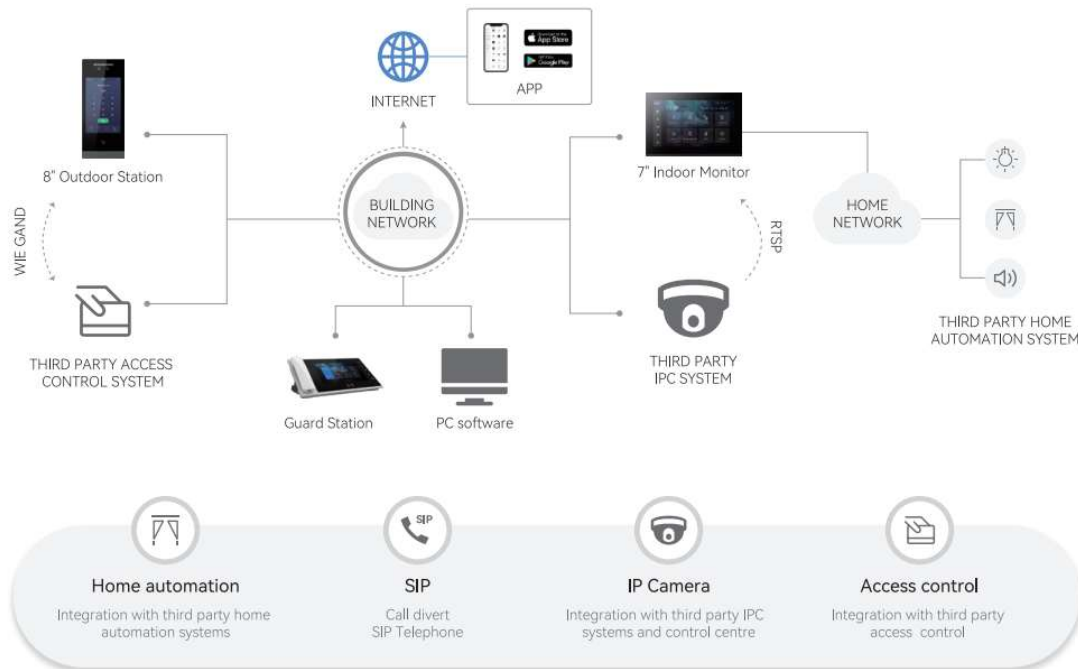

Specifications

Model	Model Number	ST-IA02
System Parameters	Processor	High-Performance Embedded SOC Processor
	Operation system	Embedded Linux Operation System
Display Parameters	Display screen	10.1-inch Colored TFT LCD
	Display resolution	1024 × 600
	Operation method	Capacitive Touch Screen
	Operation interface	Delicate Flattened UI Operation Interface
Audio Parameters	Audio input	Built-in Omnidirectional Microphone
	Audio output	Built-in Loudspeaker
	Audio compression standard	G.711 A
	Audio sample rate	16K 16 Bit
	Audio quality	Noise Elimination and Echo Cancellation
Network Parameters	Ethernet	10/100 Mbps Self-Adaptive Ethernet
	Network protocol	TCP/IP, UDP, SIP, HTTP, HTTPS, FTP, RTSP, RTP
Alarm Parameters	Alarm input	8-channel Defense Zone Alarm Inputs
Device Interfaces	Network interface	1 RJ-45 10/100 Mbps Self-Adaptive Ethernet Interface
	RS-485	1 RS-485 Half-Duplex Port
	I/O output	Unlock button
General	Memory	50 Photos
	Power supply	48V Power Over Ethernet
		DC 24V
	Power consumption	<7W 24V 300mA
	Working temperature	-10° C to + 45° C
	Working humidity	10% to 90%
	Dimensions (L × W × H)	247.5 × 165 × 17.4mm
	Certification	CE, ROHS

Appearance and Interfaces

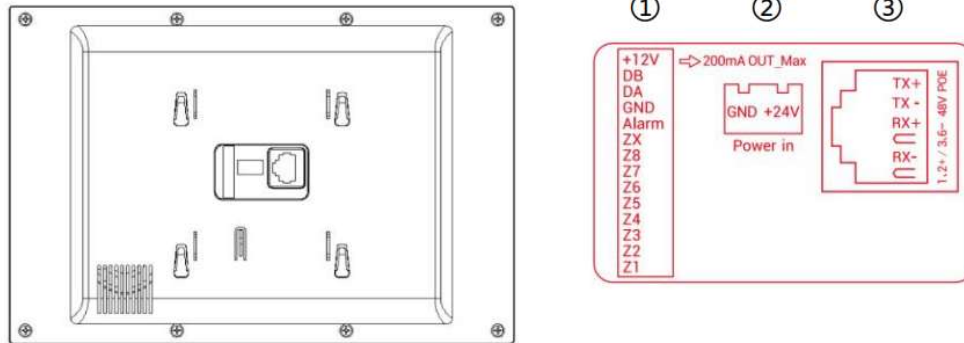

Number ①

- +12V, GND: defense area detector power terminal (current \leq 200mA);
- DB DA: RS485 interface;
- Alarm: alarm output interface (reserved);
- Z8: doorbell function as default;
- Z7 to Z1: standard defense area interface, support normal open/close security module.